

FOUNTAINS EAST PHASE 1 & 2

66 TOTAL TOWNHOMES

TYPICAL LOT DIMENSIONS
WITH END UNITS

30.00'	30.00'	25.00'	25.00'	25.00'	30.00'
100.00'					
30.00'	30.00'	25.00'	25.00'	25.00'	30.00'

Phase 1: 40 Lots



Phase 2: 26 Lots

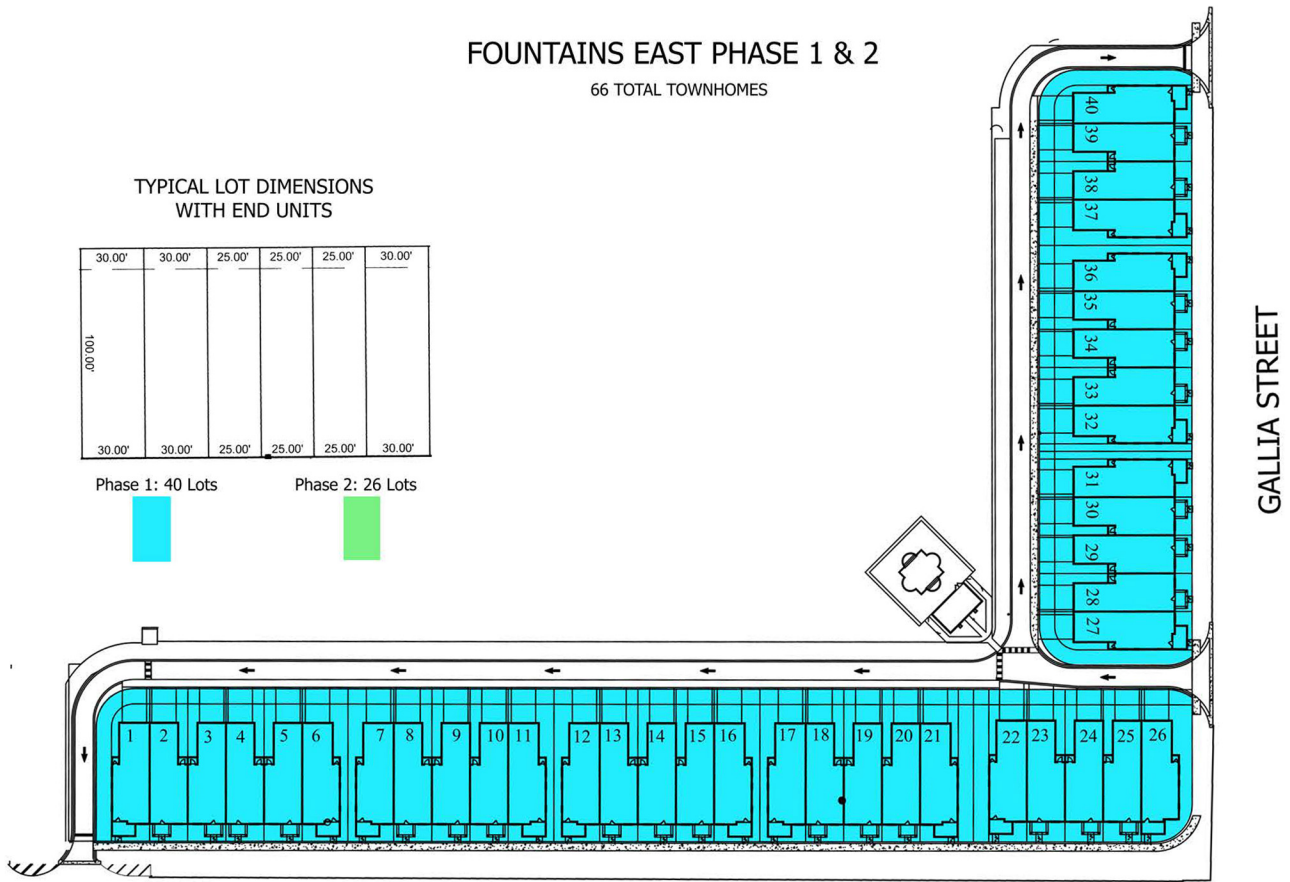

MEDICI BLVD.

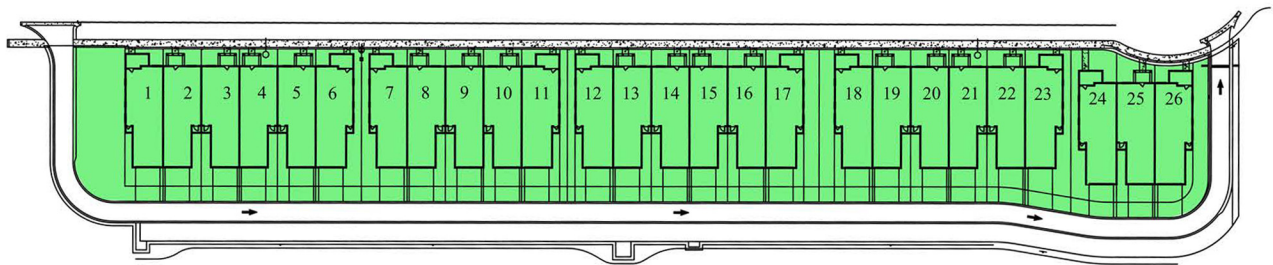

Phone: 386-690-5339 ★ Fax: 386-845-0202 ★ 424 Lune Bella Lane, Suite 112 ★ New Smyrna Beach, FL 32168
 platbuild@gmail.com ★ www.platinumbuilding-remodeling.com

Platinum Building & Remodeling, Inc. - All rights reserved, all elevations and floor plans are the exclusive property of Platinum Building & Remodeling, Inc. and may not be copied or duplicated without written permission. Platinum Builders reserves the right to modify plans, alter specifications and change dimensions without consent of or notice to the buyer. All dimensions are approximate. Artist renderings are visual depictions and may vary from actual construction.